



34, Rosary Gardens,  
, SW7

Asking Price £900,000, Leasehold

NAPIER WATT

T: 0207 935 0011  
E: [enquiries@napierwatt.co.uk](mailto:enquiries@napierwatt.co.uk)  
W: [napierwatt.co.uk](http://napierwatt.co.uk)

35 Berkeley Square, Mayfair, London, W1J 5BF











## Description

A charming two bedroom, two bathroom lower ground floor flat with high quality parquet wood flooring, located on one of South Kensington's most prestigious and convenient of locations.

Rosary Gardens is located a short walk to Gloucester Road tube station, and runs between Wetherby Place and Old Brompton Road.

Private Entrance : Entrance Hall : Reception Room With Wood Floor : Kitchen : Two Bedroom : Ensuite Bathroom : Shower Room : Patio To Rear : EPC C : Council Tax Band F

## Key Features

- PRIVATE ENTRANCE
- DESIRABLE LOCATION
- SMALL PATIO
- SOME WOOD FLOORS

## Terms

Leasehold : 11 May 1995 to 26 September 2985 ie 962 years

Service Charge £619 per quarter

EPC C.

Council Tax Kensington and Chelsea Band F

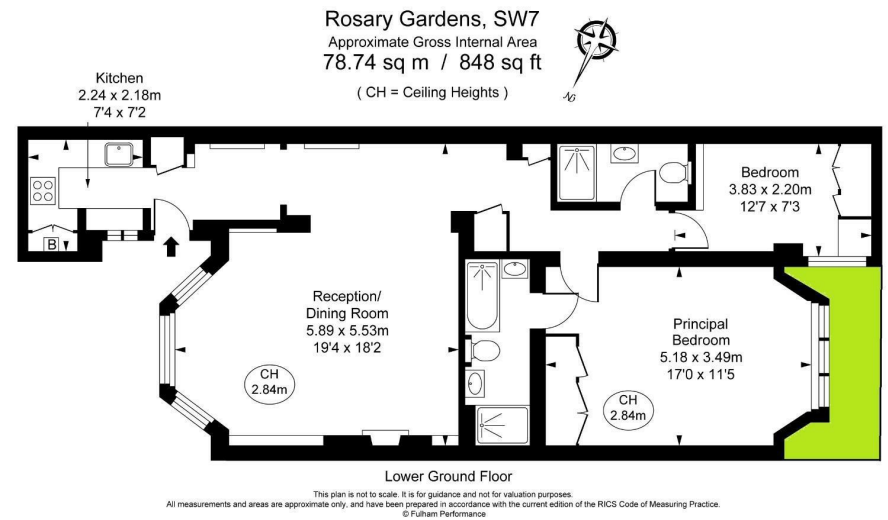

**IMPORTANT:** We would inform prospective purchasers that these sales particulars have been prepared as a general guide only. A detailed survey has not been carried out, nor the services, appliances and fittings tested. Room sizes should not be relied upon for furnishing purposes and are approximate. If floor plans are included, they are for guidance only and illustration purposes only and may not be to scale. If there are any important matters likely to affect your decision to buy, please contact us before viewing the property.